

## URBAN PROPERTY INVENTORY - EVACUEE PROPERTY DIVISION - WRA

Fresno

71

City of Fowler

TYPE: Residence CODE: \_\_\_\_\_ NO: \_\_\_\_\_LEGAL OWNERS: 1. Hirasuna, F. Y.106- 2. ", M.7336 3. ", H.

Vol. 27 (LAST NAME) (MIDDLE) (FIRST)

OWNERS' ADDRESSES: 1. Fowler

Lts. 1,2,3 2. \_\_\_\_\_

Blk. 58 3. \_\_\_\_\_

(PROJECT OR P.O.) (COUNTY) (STATE)

LOCATION OF PROPERTY: 8th St. Fowler, Fresno Co., California

(NO. AND STREET) (P.O.) (COUNTY) (STATE)

SIZE OF LOT: 3 Lots Each 25' x 150' on W Side 8th St. Between Main & Fresno Sts.

STRUCTURES: \_\_\_\_\_

ACTUAL VALUE: \$ \_\_\_\_\_ \$ \_\_\_\_\_ \$ \_\_\_\_\_

(LAND) (STRUCTURES) (TOTAL)

ASSESSED VALUE: \$ 750- \$ 325- \$ 1575-

(LAND) (STRUCTURES) (TOTAL)

OPERATED BY: \_\_\_\_\_

(NAME) (ADDRESS)

LEASE PERIOD: \_\_\_\_\_

(FROM: DATE) (TO: DATE)

INDEBTEDNESS: \$ \_\_\_\_\_

(AMOUNT) (DATE INCURRED) (DATE DUE)

CREDITOR: \_\_\_\_\_

(NAME) (ADDRESS)

REMARKS:

DISPOSITION:

DATE: MAY 18 1943

INVESTIGATOR:



URBAN PROPERTY INVENTORY - EVACUEE PROPERTY DIVISION - WRA **Fresno**

72

City of ParlierTYPE: Vacant Lot CODE: \_\_\_\_\_ NO: \_\_\_\_\_LEGAL OWNERS: 1. Hirata, Fumio

27 2. \_\_\_\_\_

7473 3. \_\_\_\_\_

Vol. 28 (LAST NAME) (MIDDLE) (FIRST)

OWNERS' ADDRESSES: 1. P.O. Box 127, Parlier, California

Lts. 15,16 2. \_\_\_\_\_

Block 2 3. \_\_\_\_\_

(PROJECT OR P.O.) (COUNTY) (STATE)

LOCATION OF PROPERTY: Fresno St., Parlier, Fresno Co., California

(NO. AND STREET) (P.O.) (COUNTY) (STATE)

SIZE OF LOT: 2 Lots Each - 25' x 150' (Corner of Fresno & K St.)

STRUCTURES: \_\_\_\_\_

ACTUAL VALUE: \$ \_\_\_\_\_ \$ \_\_\_\_\_ \$ \_\_\_\_\_

(LAND) (STRUCTURES) (TOTAL)

ASSESSED VALUE: \$ 350- \$ - \$ 350-

(LAND) (STRUCTURES) (TOTAL)

OPERATED BY: \_\_\_\_\_

(NAME) (ADDRESS)

LEASE PERIOD: \_\_\_\_\_

(FROM: DATE) (TO: DATE)

INDEBTEDNESS: \$ \_\_\_\_\_

(AMOUNT) (DATE INCURRED) (DATE DUE)

CREDITOR: \_\_\_\_\_

(NAME) (ADDRESS)

REMARKS:

DISPOSITION:

DATE: MAY 18 1943.

INVESTIGATOR:



## URBAN PROPERTY INVENTORY - EVACUEE PROPERTY DIVISION - WRA

74

## City of Reedley

TYPE: \_\_\_\_\_ CODE: \_\_\_\_\_ NO: \_\_\_\_\_

LEGAL OWNERS: 1. Hiratsuka, Shigeharu

242B 2. \_\_\_\_\_

753B 3. \_\_\_\_\_

Vol. 28 (LAST NAME) (MIDDLE) (FIRST)

OWNERS' ADDRESSES: 1. \_\_\_\_\_

2. \_\_\_\_\_

East Side Add. 3. \_\_\_\_\_

to Reedley, Lts. (PROJECT OR P.O.) (COUNTY) (STATE)

47, 48

LOCATION OF PROPERTY: August Avenue, Reedley, Fresno Co., California

(NO. AND STREET) (P.O.) (COUNTY) (STATE)

SIZE OF LOT: 2 Lts. Each 25' x 120' on SE Corner of County Road and August Avenue

STRUCTURES: \_\_\_\_\_

ACTUAL VALUE: \$ \_\_\_\_\_ \$ \_\_\_\_\_ \$ \_\_\_\_\_

(LAND) (STRUCTURES) (TOTAL)

ASSESSED VALUE: \$ 110- \$ 500- \$ 610-

(LAND) (STRUCTURES) (TOTAL)

OPERATED BY: \_\_\_\_\_

(NAME) (ADDRESS)

LEASE PERIOD: \_\_\_\_\_

(FROM: DATE) (TO: DATE)

INDEBTEDNESS: \$ \_\_\_\_\_

(AMOUNT) (DATE INCURRED) (DATE DUE)

CREDITOR: \_\_\_\_\_

(NAME) (ADDRESS)

REMARKS:

Transferred from Lela Bateman to Shig. Hiratsuka 4/6/42

Transferred from S. Hiratsuka to Carl Buxman 7/2/42

Transferred from C. Buxman to Wm. P. and Katie Bartell 12/19/42

DISPOSITION:

DATE:

INVESTIGATOR:



## URBAN PROPERTY INVENTORY - EVACUEE PROPERTY DIVISION - WRA

75

## City of Reedley

TYPE: \_\_\_\_\_ CODE: \_\_\_\_\_ NO: \_\_\_\_\_

LEGAL OWNERS: 1. Hiratsuka, Yaroaki

230B 2. \_\_\_\_\_

7529B 3. \_\_\_\_\_

Vol. 28 (LAST NAME) (MIDDLE) (FIRST)

OWNERS' ADDRESSES: 1. \_\_\_\_\_

E. Side Add. to 2. \_\_\_\_\_

Reedley Lts. 3. \_\_\_\_\_

12, 13 (PROJECT OR P.O.) (COUNTY) (STATE)

LOCATION OF PROPERTY: August Avenue, Reedley, Fresno County, California

(NO. AND STREET) (P.O.) (COUNTY) (STATE)

SIZE OF LOT: 2 Lts. Each 25' x 120' on N. Side August E. of County Road

STRUCTURES: \_\_\_\_\_

ACTUAL VALUE: \$ \_\_\_\_\_ \$ \_\_\_\_\_ \$ \_\_\_\_\_

(LAND) (STRUCTURES) (TOTAL)

ASSESSED VALUE: \$ 100- \$ 300- \$ 400-

(LAND) (STRUCTURES) (TOTAL)

OPERATED BY: \_\_\_\_\_

(NAME) (ADDRESS)

LEASE PERIOD: \_\_\_\_\_

(FROM: DATE) (TO: DATE)

INDEBTEDNESS: \$ \_\_\_\_\_

(AMOUNT) (DATE INCURRED) (DATE DUE)

CREDITOR: \_\_\_\_\_

(NAME) (ADDRESS)

REMARKS:

Transferred to Yaroku Hiratsuka from J. B. and Gertrude Ratzlaff 4/7/42

DISPOSITION:

DATE:

INVESTIGATOR:



URBAN PROPERTY INVENTORY - EVACUEE PROPERTY DIVISION - WRA **Fresno**  
City of Fowler

79

TYPE: \_\_\_\_\_ CODE: \_\_\_\_\_ NO: \_\_\_\_\_

LEGAL OWNERS: 1. Honda, Harry Mitsuo

116 2. \_\_\_\_\_

7337 3. \_\_\_\_\_

Vol. 27 (LAST NAME) (MIDDLE) (FIRST)

OWNERS' ADDRESSES: 1. Box 691, Fowler, Fresno Co., Calif.

Lts. 8 to 10 2. \_\_\_\_\_

Bl. 59 3. \_\_\_\_\_

(PROJECT OR P.O.) (COUNTY) (STATE)

LOCATION OF PROPERTY: 8th St., Fowler, Fresno Co., California

(NO. AND STREET) (P.O.) (COUNTY) (STATE)

SIZE OF LOT: 3 Lots Each - 25' x 150' on W. Side 8th Betw. Merced & Main Sts.

STRUCTURES: \_\_\_\_\_

ACTUAL VALUE: \$ \_\_\_\_\_ \$ \_\_\_\_\_ \$ \_\_\_\_\_

(LAND) (STRUCTURES) (TOTAL)

ASSESSED VALUE: \$ 450- \$ 200- \$ 650-

(LAND) (STRUCTURES) (TOTAL)

OPERATED BY: \_\_\_\_\_

(NAME) (ADDRESS)

LEASE PERIOD: \_\_\_\_\_

(FROM: DATE) (TO: DATE)

INDEBTEDNESS: \$ \_\_\_\_\_

(AMOUNT) (DATE INCURRED) (DATE DUE)

CREDITOR: \_\_\_\_\_

(NAME) (ADDRESS)

REMARKS:

DISPOSITION:

DATE: MAY 18 1943

INVESTIGATOR:



URBAN PROPERTY INVENTORY - EVACUEE PROPERTY DIVISION - WRA **Fresno**

82

## City of Reedley

TYPE: \_\_\_\_\_ CODE: \_\_\_\_\_ NO: \_\_\_\_\_

LEGAL OWNERS: 1. Ibara, Kazuo et al

805

2. Matsumura, Aichie

7587

3. \_\_\_\_\_

V-28

(LAST NAME)

(MIDDLE)

(FIRST)

OWNERS' ADDRESSES:

Lt. 26, Bl. 81

1. Reedley, Fresno Co., Calif.

2. \_\_\_\_\_

3. \_\_\_\_\_

(PROJECT OR P.O.)

(COUNTY)

(STATE)

LOCATION OF PROPERTY:

E Side J St.Reedley, Fresno Co., California

(NO. AND STREET)

(P.O.)

(COUNTY)

(STATE)

SIZE OF LOT: 25' x 150' Between 14th and 15th

STRUCTURES: \_\_\_\_\_

ACTUAL VALUE: \$

\$

\$

(LAND)

(STRUCTURES)

(TOTAL)

ASSESSED VALUE: \$

100-

\$

1200-

\$

1300-

(LAND)

(STRUCTURES)

(TOTAL)

OPERATED BY: \_\_\_\_\_

(NAME)

(ADDRESS)

LEASE PERIOD: \_\_\_\_\_

(FROM: DATE)

(TO: DATE)

INDEBTEDNESS: \$

(AMOUNT)

(DATE INCURRED)

(DATE DUE)

CREDITOR: \_\_\_\_\_

(NAME)

(ADDRESS)

REMARKS:

DISPOSITION:

DATE: MAY 18 1943

INVESTIGATOR:



## URBAN PROPERTY INVENTORY - EVACUEE PROPERTY DIVISION - WRA

Fresno

84

City of Fresno

TYPE: Residence CODE: \_\_\_\_\_ NO: \_\_\_\_\_LEGAL OWNERS: 1. Ikeda, Kazumi

360 2. \_\_\_\_\_

5135 3. \_\_\_\_\_

Vol. 18 (LAST NAME) (MIDDLE) (FIRST)

OWNERS' ADDRESSES: 1. 920 "F" Street, Fresno, California

Lt. 3 2. \_\_\_\_\_

N.W. 12 $\frac{1}{2}$ ' of 3. \_\_\_\_\_

Lt. 4 Block 31 (PROJECT OR P.O.) (COUNTY) (STATE)

LOCATION OF PROPERTY: E Street (745 E St.) Fresno, Fresno Co., California

(NO. AND STREET) (P.O.) (COUNTY) (STATE)

SIZE OF LOT: Lt. 3, 25' x 150' - Lt. 4, 12 $\frac{1}{2}$ ' x 150' (700 Block)

STRUCTURES: \_\_\_\_\_

ACTUAL VALUE: \$ \_\_\_\_\_ \$ \_\_\_\_\_ \$ \_\_\_\_\_

(LAND) (STRUCTURES) (TOTAL)

ASSESSED VALUE: \$ 300- \$ 550- \$ 850-

(LAND) (STRUCTURES) (TOTAL)

OPERATED BY: \_\_\_\_\_

(NAME) (ADDRESS)

LEASE PERIOD: \_\_\_\_\_

(FROM: DATE) (TO: DATE)

INDEBTEDNESS: \$ \_\_\_\_\_

(AMOUNT) (DATE INCURRED) (DATE DUE)

CREDITOR: \_\_\_\_\_

(NAME) (ADDRESS)

REMARKS:

DISPOSITION:

DATE: MAY 18 1943

INVESTIGATOR:



## URBAN PROPERTY INVENTORY - EVACUEE PROPERTY DIVISION - WRA

City of Fresno

TYPE: (Kogetsudo) Candy Mfg. CODE: \_\_\_\_\_ NO: \_\_\_\_\_LEGAL OWNERS: 1. Ikeda, Kazumi657 2. ", Masao

5163 3. \_\_\_\_\_

Vol. 18 (LAST NAME) (MIDDLE) (FIRST)

OWNERS' ADDRESSES: 1. 920 "F" Street, Fresno, California

Front 67.75' of 2. \_\_\_\_\_

Lots 20,21, Blk. 3. \_\_\_\_\_

51 (PROJECT OR P.O.) (COUNTY) (STATE)

LOCATION OF PROPERTY: F Street Fresno, Fresno, Co., California

(NO. AND STREET) (P.O.) (COUNTY) (STATE)

SIZE OF LOT: 2 Lots Each - 25' x 67.75' (900 Block)

STRUCTURES: \_\_\_\_\_

ACTUAL VALUE: \$ \_\_\_\_\_ \$ \_\_\_\_\_ \$ \_\_\_\_\_

(LAND) (STRUCTURES) (TOTAL)

ASSESSED VALUE: \$ 1805- \$ 1360- \$ 3165-

(LAND) (STRUCTURES) (TOTAL)

OPERATED BY: \_\_\_\_\_

(NAME) (ADDRESS)

LEASE PERIOD: \_\_\_\_\_

(FROM: DATE) (TO: DATE)

INDEBTEDNESS: \$ \_\_\_\_\_

(AMOUNT) (DATE INCURRED) (DATE DUE)

CREDITOR: \_\_\_\_\_

(NAME) (ADDRESS)

REMARKS:

DISPOSITION:

DATE: MAY 18 1943

INVESTIGATOR:



URBAN PROPERTY INVENTORY - EVACUEE PROPERTY DIVISION - WRA  
City of Fresno

Fresno

86

TYPE: Vacant Lot CODE: \_\_\_\_\_ NO: \_\_\_\_\_

LEGAL OWNERS: 1. Ikeda, Kazumi

681 2. " , Masao

5165 3. \_\_\_\_\_

Vol. 18 (LAST NAME) (MIDDLE) (FIRST)

OWNERS' ADDRESSES: 1. 920 "F" Street, Fresno

Lts. 24,25 2. \_\_\_\_\_

Vol. 53 3. \_\_\_\_\_

(PROJECT OR P.O.) (COUNTY) (STATE)

LOCATION OF PROPERTY: F Street Fresno, Fresno Co., California

(NO. AND STREET) (P.O.) (COUNTY) (STATE)

SIZE OF LOT: 2 Lots Each 25' x 150' (700 Block)

STRUCTURES: \_\_\_\_\_

ACTUAL VALUE: \$ \_\_\_\_\_ \$ \_\_\_\_\_ \$ \_\_\_\_\_

(LAND) (STRUCTURES) (TOTAL)

ASSESSED VALUE: \$ 600- \$ - \$ 600-

(LAND) (STRUCTURES) (TOTAL)

OPERATED BY: \_\_\_\_\_

(NAME) (ADDRESS)

LEASE PERIOD: \_\_\_\_\_

(FROM: DATE) (TO: DATE)

INDEBTEDNESS: \$ \_\_\_\_\_

(AMOUNT) (DATE INCURRED) (DATE DUE)

CREDITOR: \_\_\_\_\_

(NAME) (ADDRESS)

REMARKS:

DISPOSITION:

DATE: MAY 18 1943

INVESTIGATOR:



## URBAN PROPERTY INVENTORY - EVACUEE PROPERTY DIVISION - WRA

Fresno

87

City of Parlier

TYPE: Restaurant CODE: \_\_\_\_\_ NO: \_\_\_\_\_LEGAL OWNERS: 1. Ikemoto, Shiwa

90 2. \_\_\_\_\_

7480 3. \_\_\_\_\_

Vol. 28 (LAST NAME) (MIDDLE) (FIRST)

OWNERS' ADDRESSES: 1. Box 146, Parlier, California

2nd Add. to 2. \_\_\_\_\_

town of Parlier 3. \_\_\_\_\_

Lot 9 Less E 6 $\frac{1}{2}$ " (PROJECT OR P.O.) (COUNTY) (STATE)LOCATION OF PROPERTY: Fresno Street Parlier, Fresno Co., California

of N70' Thereof\* (NO. AND STREET) (P.O.) (COUNTY) (STATE)

SIZE OF LOT: 25' x 150' Less 6 $\frac{1}{2}$ " x 70' on E Line of Property - Fresno Between K andSTRUCTURES: \_\_\_\_\_ Newmark

ACTUAL VALUE: \$ \_\_\_\_\_ \$ \_\_\_\_\_ \$ \_\_\_\_\_

(LAND) (STRUCTURES) (TOTAL)

ASSESSED VALUE: \$ 145- \$ 400- \$ 545-

(LAND) (STRUCTURES) (TOTAL)

OPERATED BY: \_\_\_\_\_

(NAME) (ADDRESS)

LEASE PERIOD: \_\_\_\_\_

(FROM: DATE) (TO: DATE)

INDEBTEDNESS: \$ \_\_\_\_\_

(AMOUNT) (DATE INCURRED) (DATE DUE)

CREDITOR: \_\_\_\_\_

(NAME) (ADDRESS)

\*Block 9

REMARKS:

DISPOSITION:

DATE: MAY 18 1943

INVESTIGATOR:



URBAN PROPERTY INVENTORY - EVACUEE PROPERTY DIVISION - WRA **Fresno**  
City of Fowler

88

TYPE: \_\_\_\_\_ CODE: \_\_\_\_\_ NO: \_\_\_\_\_

LEGAL OWNERS: 1. Imada, G.  
103 2. Okada, K.  
7336 3. \_\_\_\_\_

Vol. 27 (LAST NAME) (MIDDLE) (FIRST)

OWNERS' ADDRESSES: 1. c/o E. Iwamoto, P.O. Box 465, Fowler, Fresno Co., Calif.  
Rear of  $\frac{1}{2}$  of Lts. 2. \_\_\_\_\_  
5 to 7, Bl. 57 3. \_\_\_\_\_

(PROJECT OR P.O.) (COUNTY) (STATE)

LOCATION OF PROPERTY: 8th St. (Rear), Fowler, Fresno Co., California  
(NO. AND STREET) (P.O.) (COUNTY) (STATE) Fresno &

SIZE OF LOT: 3 Lots Each 25' x 75' - Lots Face Alley Between 8th & 9th & Betw. Tuolumne  
Streets

STRUCTURES: \_\_\_\_\_

ACTUAL VALUE: \$ \_\_\_\_\_ \$ \_\_\_\_\_ \$ \_\_\_\_\_  
(LAND) (STRUCTURES) (TOTAL)

ASSESSED VALUE: \$ 75- \$ 50- \$ 125-  
(LAND) (STRUCTURES) (TOTAL)

OPERATED BY: \_\_\_\_\_  
(NAME) (ADDRESS)

LEASE PERIOD: \_\_\_\_\_  
(FROM: DATE) (TO: DATE)

INDEBTEDNESS: \$ \_\_\_\_\_  
(AMOUNT) (DATE INCURRED) (DATE DUE)

CREDITOR: \_\_\_\_\_  
(NAME) (ADDRESS)

REMARKS:

DISPOSITION:

DATE: MAY 18 1943

INVESTIGATOR:



## URBAN PROPERTY INVENTORY - EVACUEE PROPERTY DIVISION - WRA

Fresno

89

Fresno, City of

TYPE: Residence CODE: \_\_\_\_\_ NO: \_\_\_\_\_LEGAL OWNERS: 1. Imada, Yoshiyuki

400 2. \_\_\_\_\_

5138 3. \_\_\_\_\_

Vol. 18 (LAST NAME) (MIDDLE) (FIRST)

OWNERS' ADDRESSES: 1. 6 Mrs. Thomas Lopez, 1523 Webster St., Fresno

Lts. 23, 24, 2. \_\_\_\_\_

Blk. 33 3. \_\_\_\_\_

(PROJECT OR P.O.) (COUNTY) (STATE)

LOCATION OF PROPERTY: D Street Fresno, Fresno Co., California

(NO. AND STREET) (P.O.) (COUNTY) (STATE)

SIZE OF LOT: 2 Lts. Each 25' x 150' (Block-500) (532 D St.)

STRUCTURES: \_\_\_\_\_

ACTUAL VALUE: \$ \_\_\_\_\_ \$ \_\_\_\_\_ \$ \_\_\_\_\_

(LAND) (STRUCTURES) (TOTAL)

ASSESSED VALUE: \$ 300- \$ 410- \$ 710-

(LAND) (STRUCTURES) (TOTAL)

OPERATED BY: \_\_\_\_\_

(NAME) (ADDRESS)

LEASE PERIOD: \_\_\_\_\_

(FROM: DATE) (TO: DATE)

INDEBTEDNESS: \$ \_\_\_\_\_

(AMOUNT) (DATE INCURRED) (DATE DUE)

CREDITOR: \_\_\_\_\_

(NAME) (ADDRESS)

REMARKS:

DISPOSITION:

DATE: MAY 18 1943

INVESTIGATOR:



## URBAN PROPERTY INVENTORY - EVACUEE PROPERTY DIVISION - WRA

Fresno

90

City of Fresno

TYPE: Grocery CODE: \_\_\_\_\_ NO: \_\_\_\_\_LEGAL OWNERS: 1. Inami, S.

182 2. \_\_\_\_\_

5117 3. \_\_\_\_\_

Vol. 18 (LAST NAME) (MIDDLE) (FIRST)

OWNERS' ADDRESSES: 1. 926 "F" Street, Fresno, California

Rear 50' of 2. \_\_\_\_\_

Its. 1-6 3. \_\_\_\_\_

Block 16 (PROJECT OR P.O.) (COUNTY) (STATE) \*

LOCATION OF PROPERTY: Tulare Street Fresno, Fresno Co., California

(NO. AND STREET) (P.O.) (COUNTY) (STATE) (1200

SIZE OF LOT: 50' x 150' (This lot is the rear 50' of Lots 1-6 on D. St., 900 Block) Block)

STRUCTURES: \_\_\_\_\_

ACTUAL VALUE: \$ \_\_\_\_\_ \$ \_\_\_\_\_ \$ \_\_\_\_\_

(LAND) (STRUCTURES) (TOTAL)

ASSESSED VALUE: \$ 350- \$ 1200- \$ 1550-

(LAND) (STRUCTURES) (TOTAL)

OPERATED BY: \_\_\_\_\_

(NAME) (ADDRESS)

LEASE PERIOD: \_\_\_\_\_

(FROM: DATE) (TO: DATE)

INDEBTEDNESS: \$ \_\_\_\_\_

(AMOUNT) (DATE INCURRED) (DATE DUE)

CREDITOR: \_\_\_\_\_

(NAME) (ADDRESS)

\*1228 Tulare

REMARKS:

DISPOSITION:

DATE: MAY 18 1943

INVESTIGATOR:



## URBAN PROPERTY INVENTORY - EVACUEE PROPERTY DIVISION - WRA

Fresno

91

City of Fresno

TYPE: Restaurant CODE: \_\_\_\_\_ NO: \_\_\_\_\_LEGAL OWNERS: 1. Inami, S.

660 2. \_\_\_\_\_

5163 3. \_\_\_\_\_

Vol. 18 (LAST NAME) (MIDDLE) (FIRST)

OWNERS' ADDRESSES: 1. 926 "E" Street, Fresno, California

Front 41.5' of 2. \_\_\_\_\_

Lts. 22, 23 - 3. \_\_\_\_\_

Block 51 (PROJECT OR P.O.) (COUNTY) (STATE)

LOCATION OF PROPERTY: F Street Fresno, Fresno Co., California

(NO. AND STREET) (P.O.) (COUNTY) (STATE)

SIZE OF LOT: 2 Lots - Each 25' x 41.5' (900 block)

STRUCTURES: \_\_\_\_\_

ACTUAL VALUE: \$ \_\_\_\_\_ \$ \_\_\_\_\_ \$ \_\_\_\_\_

(LAND) (STRUCTURES) (TOTAL)

ASSESSED VALUE: \$ 1105- \$ 740- \$ 1845-

(LAND) (STRUCTURES) (TOTAL)

OPERATED BY: \_\_\_\_\_

(NAME) (ADDRESS)

LEASE PERIOD: \_\_\_\_\_

(FROM: DATE) (TO: DATE)

INDEBTEDNESS: \$ \_\_\_\_\_

(AMOUNT) (DATE INCURRED) (DATE DUE)

CREDITOR: \_\_\_\_\_

(NAME) (ADDRESS)

REMARKS:

DISPOSITION:

DATE: MAY 18 1943

INVESTIGATOR:



URBAN PROPERTY INVENTORY - EVACUEE PROPERTY DIVISION - WRA **Fresno**  
City of Fresno

92

TYPE: Residence CODE: \_\_\_\_\_ NO: \_\_\_\_\_

LEGAL OWNERS: 1. Inouye, Teruichi

4271- 2. \_\_\_\_\_

5527 3. \_\_\_\_\_

Vol. 19 (LAST NAME) (MIDDLE) (FIRST)

OWNERS' ADDRESSES: 1. 1402 Kern Street, Fresno

Paige Tract, 2. \_\_\_\_\_

Lts. 10, 11 3. \_\_\_\_\_

NW $\frac{1}{2}$  of Lt. 12 (PROJECT OR P.O.) (COUNTY) (STATE)

LOCATION OF PROPERTY: Mayor Avenue Fresno, Fresno Co., California (823 Mayor)

Blk. 10 (NO. AND STREET) (P.O.) (COUNTY) (STATE)

SIZE OF LOT: 2 Lts. Each 25' x 150' - 1 Lot 12 $\frac{1}{2}$ ' x 150' on W Side Mayor Ave., Betw.

STRUCTURES: Inyo and Kern

ACTUAL VALUE: \$ \_\_\_\_\_ \$ \_\_\_\_\_ \$ \_\_\_\_\_

(LAND) (STRUCTURES) (TOTAL)

ASSESSED VALUE: \$ 250- \$ 2080- \$ 2330-

(LAND) (STRUCTURES) (TOTAL)

OPERATED BY: \_\_\_\_\_

(NAME) (ADDRESS)

LEASE PERIOD: \_\_\_\_\_

(FROM: DATE) (TO: DATE)

INDEBTEDNESS: \$ \_\_\_\_\_

(AMOUNT) (DATE INCURRED) (DATE DUE)

CREDITOR: \_\_\_\_\_

(NAME) (ADDRESS)

REMARKS:

DISPOSITION:

DATE: MAY 18 1943

INVESTIGATOR:



## URBAN PROPERTY INVENTORY - EVACUEE PROPERTY DIVISION - WRA

94

## City of Fresno

TYPE: \_\_\_\_\_ CODE: \_\_\_\_\_ NO: \_\_\_\_\_

LEGAL OWNERS: 1. Ishida, Teruo

15463 2. \_\_\_\_\_

6744 3. \_\_\_\_\_

Vol. 25, Div. (LAST NAME) (MIDDLE) (FIRST)

OWNERS' ADDRESSES: 1. \_\_\_\_\_

6-12 2. \_\_\_\_\_

Florence - Lt. 83. \_\_\_\_\_

Block 5 (PROJECT OR P.O.) (COUNTY) (STATE)

LOCATION OF PROPERTY: \_\_\_\_\_

(NO. AND STREET) (P.O.) (COUNTY) (STATE)

SIZE OF LOT: 60' x 135' W. Side Eunice Between Lorena and Florence Avenues

STRUCTURES: \_\_\_\_\_

ACTUAL VALUE: \$ \_\_\_\_\_ \$ \_\_\_\_\_ \$ \_\_\_\_\_

(LAND) (STRUCTURES) (TOTAL)

ASSESSED VALUE: \$ 20- \$ - \$ 120-

(LAND) (STRUCTURES) (TOTAL)

OPERATED BY: \_\_\_\_\_

(NAME) (ADDRESS)

LEASE PERIOD: \_\_\_\_\_

(FROM: DATE) (TO: DATE)

INDEBTEDNESS: \$ \_\_\_\_\_

(AMOUNT) (DATE INCURRED) (DATE DUE)

CREDITOR: \_\_\_\_\_

(NAME) (ADDRESS)

REMARKS:

Transferred from Ishida, Teruo to Khan, Zalinda Oty 4/13/42  
P. O. Box 193, Selma, California

DISPOSITION:

DATE:

INVESTIGATOR:



## URBAN PROPERTY INVENTORY - EVACUEE PROPERTY DIVISION - WRA

Fresno

103

City of Selma

TYPE: (Chop Suey) Restaurant CODE: \_\_\_\_\_ NO: \_\_\_\_\_LEGAL OWNERS: 1. Ito, H.

340 2. \_\_\_\_\_

7808 3. \_\_\_\_\_

Vol. 29 (LAST NAME) (MIDDLE) (FIRST)

OWNERS' ADDRESSES: 1. P.O. Box 4, Selma, California

Cent. Add. to 2. \_\_\_\_\_

Selma Por. of 3. \_\_\_\_\_

Lt. 5, Blk. 1 (PROJECT OR P.O.) (COUNTY) (STATE)

LOCATION OF PROPERTY: W. Front Street Selma, Fresno Co., California

(Over) (NO. AND STREET) (P.O.) (COUNTY) (STATE)

SIZE OF LOT: 20' x 50' SE McCall Road

STRUCTURES: \_\_\_\_\_

ACTUAL VALUE: \$ \_\_\_\_\_ \$ \_\_\_\_\_ \$ \_\_\_\_\_

(LAND) (STRUCTURES) (TOTAL)

ASSESSED VALUE: \$ 100- \$ 1100- \$ 1200-

(LAND) (STRUCTURES) (TOTAL)

OPERATED BY: \_\_\_\_\_

(NAME) (ADDRESS)

LEASE PERIOD: \_\_\_\_\_

(FROM: DATE) (TO: DATE)

INDEBTEDNESS: \$ \_\_\_\_\_

(AMOUNT) (DATE INCURRED) (DATE DUE)

CREDITOR: \_\_\_\_\_

(NAME) (ADDRESS)

REMARKS:

Described As: Beg. at Ely. Cor. of Lt. 5, Th. NW Along NE Line of  
Said Lot, 20': Th. SWLY 50': Th. SE 20' Th. NeLy 50' to Beg.

DISPOSITION:

DATE: MAY 18 1943

INVESTIGATOR:



URBAN PROPERTY INVENTORY - EVACUEE PROPERTY DIVISION - WRA **Fresno**

105

## City of Fowler

TYPE: \_\_\_\_\_ CODE: \_\_\_\_\_ NO: \_\_\_\_\_

LEGAL OWNERS: 1. Iwamoto, Virginia T.102 2. Iwamoto, Dick R.

7336 3. \_\_\_\_\_

Vol. 27 (LAST NAME) (MIDDLE) (FIRST)

OWNERS' ADDRESSES: 1. P.O. Box 465, Fowler, Fresno Co., Calif.

Front 75' of Lts. 2. \_\_\_\_\_

1 to 7, Blk. 57 3. \_\_\_\_\_

LOCATION OF PROPERTY: (PROJECT OR P.O.) (COUNTY) (STATE)

8th St., Fowler, Fresno Co., California

(NO. AND STREET) (P.O.) (COUNTY) (STATE)

SIZE OF LOT: 7 Lots Each - 25' x 75' on W. Side 8th Betw. Fresno & Tuolumne Sts.

STRUCTURES: \_\_\_\_\_

ACTUAL VALUE: \$ \_\_\_\_\_ \$ \_\_\_\_\_ \$ \_\_\_\_\_

(LAND) (STRUCTURES) (TOTAL)

ASSESSED VALUE: \$ 400- \$ 800- \$ 1200-

(LAND) (STRUCTURES) (TOTAL)

OPERATED BY: \_\_\_\_\_

(NAME) (ADDRESS)

LEASE PERIOD: \_\_\_\_\_

(FROM: DATE) (TO: DATE)

INDEBTEDNESS: \$ \_\_\_\_\_

(AMOUNT) (DATE INCURRED) (DATE DUE)

CREDITOR: \_\_\_\_\_

(NAME) (ADDRESS)

REMARKS:

DISPOSITION:

DATE: MAY 18 1943

INVESTIGATOR:



## URBAN PROPERTY INVENTORY - EVACUEE PROPERTY DIVISION - WRA

Fresno

112

City of Fowler

TYPE: Church CODE: \_\_\_\_\_ NO: \_\_\_\_\_LEGAL OWNERS: 1. Japanese Community Church of Fowler

469 2. \_\_\_\_\_

7375 3. \_\_\_\_\_

Vol. 27 (LAST NAME) (MIDDLE) (FIRST)

OWNERS' ADDRESSES: 1. LoK. Osaki, Route 1, Box 105, Fowler

All of Blk. 25 2. \_\_\_\_\_

3. \_\_\_\_\_

(PROJECT OR P.O.) (COUNTY) (STATE)

LOCATION OF PROPERTY: Fowler, Fresno Co., California

(NO. AND STREET) (P.O.) (COUNTY) (STATE) (2.75500)

SIZE OF LOT: 32 Lots Each - 25' x 150' Bounded by 4th, Fresno, 5th and Vine Streets

STRUCTURES: \_\_\_\_\_

ACTUAL VALUE: \$ \_\_\_\_\_ \$ \_\_\_\_\_ \$ \_\_\_\_\_

(LAND) (STRUCTURES) (TOTAL)

ASSESSED VALUE: \$ 1020- \$ 1000- \$ 2020-

(LAND) (STRUCTURES) (TOTAL)

OPERATED BY: \_\_\_\_\_

(NAME) (ADDRESS)

LEASE PERIOD: \_\_\_\_\_

(FROM: DATE) (TO: DATE)

INDEBTEDNESS: \$ \_\_\_\_\_

(AMOUNT) (DATE INCURRED) (DATE DUE)

CREDITOR: \_\_\_\_\_

(NAME) (ADDRESS)

\* Not counted as transfer — Delinquent Tax Case

REMARKS:     Transferred to City of Fowler 8/5/42.

DISPOSITION:

DATE: MAY 18 1943

INVESTIGATOR:



URBAN PROPERTY INVENTORY - EVACUEE PROPERTY DIVISION - WRA **Fresno**

See Card #114

113

## I\* City of Parlier

TYPE: Church CODE: \_\_\_\_\_ NO: \_\_\_\_\_LEGAL OWNERS: 1. Japanese Community Church of Parlier

239 2. \_\_\_\_\_

7496 - Vol. 3. \_\_\_\_\_

28 (LAST NAME) (MIDDLE) (FIRST)

OWNERS' ADDRESSES: 1. c/o Chiameri, Secretary, Parlier, California

2nd Add. to 2. \_\_\_\_\_

Town of Parlier 3. \_\_\_\_\_

Lots 13,16 (PROJECT OR P.O.) (COUNTY) (STATE)

LOCATION OF PROPERTY: Fresno Street Parlier, Fresno Co., California

Block 9 (NO. AND STREET) (P.O.) (COUNTY) (STATE)

SIZE OF LOT: 4 Lots Each - 25' x 150' on S. Side Fresno Between K. and Newmark Sts.

STRUCTURES: \_\_\_\_\_

ACTUAL VALUE: \$ \_\_\_\_\_ \$ \_\_\_\_\_ \$ \_\_\_\_\_

(LAND) (STRUCTURES) (TOTAL)

ASSESSED VALUE: \$ 600- \$ 900- \$ 1500- (Exempt)

(LAND) (STRUCTURES) (TOTAL)

OPERATED BY: \_\_\_\_\_

(NAME) (ADDRESS)

LEASE PERIOD: \_\_\_\_\_

(FROM: DATE) (TO: DATE)

INDEBTEDNESS: \$ \_\_\_\_\_

(AMOUNT) (DATE INCURRED) (DATE DUE)

CREDITOR: \_\_\_\_\_

(NAME) (ADDRESS)

\* See Card II for Other Property, Same No.

REMARKS:

DISPOSITION:

DATE: MAY 18 1943

INVESTIGATOR:



URBAN PROPERTY INVENTORY - EVACUEE PROPERTY DIVISION - WRA **Fresno**  
City of Parlier

See Card #113 114

II\* TYPE: Church CODE: \_\_\_\_\_ NO: \_\_\_\_\_

LEGAL OWNERS: 1. Japanese Community Church of Parlier

239 2. \_\_\_\_\_

7496 3. \_\_\_\_\_

Vol. 28 (LAST NAME) (MIDDLE) (FIRST)

OWNERS' ADDRESSES: 1. 90 K. Chiamori, Secretary, Parlier, California

2nd Add. to town 2. \_\_\_\_\_

of Parlier 3. \_\_\_\_\_

Lots 31-35 and (PROJECT OR P.O.) (COUNTY) (STATE)

LOCATION OF PROPERTY: Tulare Street, Parlier, Fresno, California

por. of Lot 30, Blk. 9 (NO. AND STREET) (P.O.) (COUNTY) (STATE)

SIZE OF LOT: 5 lots, 25' x 150' S side Tulare between K and Newmark Streets

STRUCTURES: \_\_\_\_\_

ACTUAL VALUE: \$ \_\_\_\_\_ \$ \_\_\_\_\_ \$ \_\_\_\_\_

(LAND) (STRUCTURES) (TOTAL)

ASSESSED VALUE: \$ 500 \$ 900 \$ 1400

(LAND) (STRUCTURES) (TOTAL)

OPERATED BY: \_\_\_\_\_

(NAME) (ADDRESS)

LEASE PERIOD: \_\_\_\_\_

(FROM: DATE) (TO: DATE)

INDEBTEDNESS: \$ \_\_\_\_\_

(AMOUNT) (DATE INCURRED) (DATE DUE)

CREDITOR: \_\_\_\_\_

(NAME) (ADDRESS)

\*See Card I for other property, same no.

REMARKS:

DISPOSITION:

DATE: MAY 18 1943

INVESTIGATOR:



## URBAN PROPERTY INVENTORY - EVACUEE PROPERTY DIVISION - WRA

Fresno

115

City of Reedley  
TYPE: Church CODE: \_\_\_\_\_ NO: \_\_\_\_\_  
LEGAL OWNERS: 1. Japanese Community Church of Reedley  
479 2. \_\_\_\_\_  
7554 3. \_\_\_\_\_  
Vol. 28 (LAST NAME) (MIDDLE) (FIRST)  
OWNERS' ADDRESSES: 1. P.O. Box 245, Reedley, California  
Lots 17 to 20 2. \_\_\_\_\_  
Block 81 3. \_\_\_\_\_  
(PROJECT OR P.O.) (COUNTY) (STATE)  
LOCATION OF PROPERTY: J Street Reedley, Fresno Co., California  
(NO. AND STREET) (P.O.) (COUNTY) (STATE)  
SIZE OF LOT: 4 Lts. Each - 25' x 150' NW Corner J St. and 15th  
STRUCTURES: \_\_\_\_\_  
ACTUAL VALUE: \$ \_\_\_\_\_ \$ \_\_\_\_\_ \$ \_\_\_\_\_  
(LAND) (STRUCTURES) (TOTAL)  
ASSESSED VALUE: \$ 425- \$ 600- \$ 1025- (Not Exempt)  
(LAND) (STRUCTURES) (TOTAL)  
OPERATED BY: \_\_\_\_\_  
(NAME) (ADDRESS)  
LEASE PERIOD: \_\_\_\_\_  
(FROM: DATE) (TO: DATE)  
INDEBTEDNESS: \$ \_\_\_\_\_  
(AMOUNT) (DATE INCURRED) (DATE DUE)  
CREDITOR: \_\_\_\_\_  
(NAME) (ADDRESS)

REMARKS:

DISPOSITION:

DATE: MAY 18 1943

INVESTIGATOR:



## URBAN PROPERTY INVENTORY - EVACUEE PROPERTY DIVISION - WRA

Fresno

116

City of Fresno

TYPE: Church CODE: \_\_\_\_\_ NO: \_\_\_\_\_LEGAL OWNERS: 1. Japanese First Methodist Church

168 2. \_\_\_\_\_

5116 3. \_\_\_\_\_

Vol. 18 (LAST NAME) (MIDDLE) (FIRST)

OWNERS' ADDRESSES: 1. 1260 Kern Street, Fresno, CaliforniaRear  $\frac{1}{2}$  of Lts. 2. \_\_\_\_\_1-4, Front  $\frac{1}{2}$  of 3. \_\_\_\_\_

Lts. 1-4, Blk. 15 (PROJECT OR P.O.) (COUNTY) (STATE)

LOCATION OF PROPERTY: D Street Fresno, Fresno Co., California

(NO. AND STREET) (P.O.) (COUNTY) (STATE)

SIZE OF LOT: \*Rear  $\frac{1}{2}$  4 Lots - Each 25' x 75'; Front  $\frac{1}{4}$  4 Lots - Each 25' x 75' (800 Block)

STRUCTURES: \_\_\_\_\_

ACTUAL VALUE: \$ \_\_\_\_\_ \$ \_\_\_\_\_ \$ \_\_\_\_\_

(LAND) Parsonage 350 (STRUCTURES) 650 (TOTAL)ASSESSED VALUE: \$ Church 400 \$ 800 \$ (1200-Exempt) 1000- -

(LAND) (STRUCTURES) (TOTAL)

OPERATED BY: \_\_\_\_\_

(NAME) (ADDRESS)

LEASE PERIOD: \_\_\_\_\_

(FROM: DATE) (TO: DATE)

INDEBTEDNESS: \$ \_\_\_\_\_

(AMOUNT) (DATE INCURRED) (DATE DUE)

CREDITOR: \_\_\_\_\_

(NAME) (ADDRESS)

\*(Rear  $\frac{1}{2}$  is Parsonage and Front  $\frac{1}{2}$  is Church)

REMARKS:

DISPOSITION:

DATE: MAY 18 1943

INVESTIGATOR:



URBAN PROPERTY INVENTORY - EVACUEE PROPERTY DIVISION - WRA **Fresno**  
City of Selma

117

TYPE: \_\_\_\_\_ CODE: \_\_\_\_\_ NO: \_\_\_\_\_

LEGAL OWNERS: 1. Kajitani, Iko (Nobusada)

7 2. \_\_\_\_\_

7771 3. \_\_\_\_\_

City of Selma (LAST NAME) (MIDDLE) (FIRST)

OWNERS' ADDRESSES: 1. 1605 W. Front St., Selma, Fresno Co., Calif.

Lts. 24, 25 2. \_\_\_\_\_

Blk. A. 3. \_\_\_\_\_

Vol. 29 (PROJECT OR P.O.) (COUNTY) (STATE)

LOCATION OF PROPERTY: N.W. Corner W. Front & 3rd Selma, Fresno Co., California

(NO. AND STREET) (P.O.) (COUNTY) (STATE)

SIZE OF LOT: 2 Lts. Each - 30' x 120' (1800 Block W. Front St.)

STRUCTURES: \_\_\_\_\_

ACTUAL VALUE: \$ \_\_\_\_\_ \$ \_\_\_\_\_ \$ \_\_\_\_\_

(LAND) (STRUCTURES) (TOTAL)

ASSESSED VALUE: \$ 800- \$ 840- \$ 1640-

(LAND) (STRUCTURES) (TOTAL)

OPERATED BY: \_\_\_\_\_

(NAME) (ADDRESS)

LEASE PERIOD: \_\_\_\_\_

(FROM: DATE) (TO: DATE)

INDEBTEDNESS: \$ \_\_\_\_\_

(AMOUNT) (DATE INCURRED) (DATE DUE)

CREDITOR: \_\_\_\_\_

(NAME) (ADDRESS)

REMARKS:

DISPOSITION:

DATE: MAY 18 1943

INVESTIGATOR:



URBAN PROPERTY INVENTORY - EVACUEE PROPERTY DIVISION - WRA  
City of Selma

Fresno

118

TYPE: \_\_\_\_\_ CODE: \_\_\_\_\_ NO: \_\_\_\_\_

LEGAL OWNERS: 1. Kajitani, Iko

8 2. \_\_\_\_\_

7771 3. \_\_\_\_\_

Vol. 29 (LAST NAME) (MIDDLE) (FIRST)

OWNERS' ADDRESSES: 1. 1605 W. Front St., Selma, Fresno Co., California

Lts. 29-32 - Less 2. \_\_\_\_\_

State Hi'way, 3. \_\_\_\_\_

Blk. A (PROJECT OR P.O.) (COUNTY) (STATE)

LOCATION OF PROPERTY: N.E. Corner 3rd & Whitson, Selma, Fresno Co., California

(NO. AND STREET) (P.O.) (COUNTY) (STATE)

SIZE OF LOT: 4 Lts. 30' x 120'

STRUCTURES: \_\_\_\_\_

ACTUAL VALUE: \$ \_\_\_\_\_ \$ \_\_\_\_\_ \$ \_\_\_\_\_

(LAND) (STRUCTURES) (TOTAL)

ASSESSED VALUE: \$ 1020- \$ 2730- \$ 3750-

(LAND) (STRUCTURES) (TOTAL)

OPERATED BY: \_\_\_\_\_

(NAME) (ADDRESS)

LEASE PERIOD: \_\_\_\_\_

(FROM: DATE) (TO: DATE)

INDEBTEDNESS: \$ \_\_\_\_\_

(AMOUNT) (DATE INCURRED) (DATE DUE)

CREDITOR: \_\_\_\_\_

(NAME) (ADDRESS)

REMARKS:

DISPOSITION:

DATE: MAY 18 1943

INVESTIGATOR:



## URBAN PROPERTY INVENTORY - EVACUEE PROPERTY DIVISION - WRA

Fresno

119

City of Selma

TYPE: Kajitani Company CODE: \_\_\_\_\_ NO: \_\_\_\_\_LEGAL OWNERS: 1. Kajitani, Iko (Nobusada)

26 2. \_\_\_\_\_

7773 3. \_\_\_\_\_

Vol. 29 (LAST NAME) (MIDDLE) (FIRST)

OWNERS' ADDRESSES: 1. 1625 W. Front Street, Selma, California

Lts. 23,24 2. \_\_\_\_\_

Less State Hi'way 3. \_\_\_\_\_

Blk. C (PROJECT OR P.O.) (COUNTY) (STATE)

LOCATION OF PROPERTY: Whitson St. Selma, Fresno Co., California

(NO. AND STREET) (P.O.) (COUNTY) (STATE)

SIZE OF LOT: 2 Lots 30' x 120' (2000 Block)

STRUCTURES: \_\_\_\_\_

ACTUAL VALUE: \$ \_\_\_\_\_ \$ \_\_\_\_\_ \$ \_\_\_\_\_

(LAND) (STRUCTURES) (TOTAL)

ASSESSED VALUE: \$ 420- \$ 450- \$ 870-

(LAND) (STRUCTURES) (TOTAL)

OPERATED BY: \_\_\_\_\_

(NAME) (ADDRESS)

LEASE PERIOD: \_\_\_\_\_

(FROM: DATE) (TO: DATE)

INDEBTEDNESS: \$ \_\_\_\_\_

(AMOUNT) (DATE INCURRED) (DATE DUE)

CREDITOR: \_\_\_\_\_

(NAME) (ADDRESS)

REMARKS:

DISPOSITION:

DATE:

MAY 18 1943

INVESTIGATOR:



URBAN PROPERTY INVENTORY - EVACUEE PROPERTY DIVISION - WRA  
City of Selma

Fresno

120

TYPE: \_\_\_\_\_ CODE: \_\_\_\_\_ NO: \_\_\_\_\_

LEGAL OWNERS: 1. Kajitani, Iko (Nobusada)  
339-7808-Vol. 2. \_\_\_\_\_  
29, Cent. Add. 3. \_\_\_\_\_  
to Selma-Lts. 3, 4 (LAST NAME) (MIDDLE) (FIRST)

OWNERS' ADDRESSES: 1. 1605 W. Front St., Selma, Fresno Co., Calif.  
& Frcl. Lts. 2, 10, 11, 2. \_\_\_\_\_  
& Por. of Lts. 9, 12 3. \_\_\_\_\_  
& Por. of SW  $\frac{1}{4}$  of SW  $\frac{1}{4}$  of (PROJECT OR P.O.) (COUNTY) (STATE)

LOCATION OF PROPERTY: E Side McCall Rd. Selma, Fresno Co., California  
Sec. 5, 16/22 (Des. as) (NO. AND STREET) (P.O.) (COUNTY) (STATE)

SIZE OF LOT: Bl. 1 (Over) S. of W. Front St.

STRUCTURES: \_\_\_\_\_

ACTUAL VALUE: \$ \_\_\_\_\_ \$ \_\_\_\_\_ \$ \_\_\_\_\_

	(LAND)	(STRUCTURES)	(TOTAL)
ASSESSED VALUE: \$	<u>675-</u>	<u>2100-</u>	<u>2775-</u>
	(LAND)	(STRUCTURES)	(TOTAL)

OPERATED BY: \_\_\_\_\_  
(NAME) (ADDRESS)

LEASE PERIOD: \_\_\_\_\_  
(FROM: DATE) (TO: DATE)

INDEBTEDNESS: \$ \_\_\_\_\_  
(AMOUNT) (DATE INCURRED) (DATE DUE)

CREDITOR: \_\_\_\_\_  
(NAME) (ADDRESS)

REMARKS:

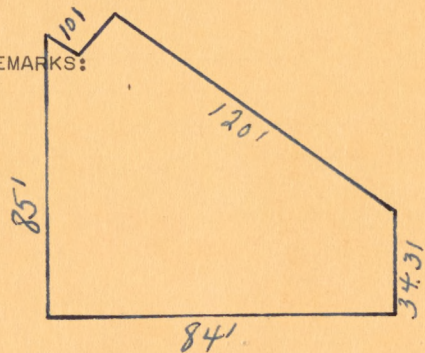

DISPOSITION:

DATE: MAY 18 1943

INVESTIGATOR:



URBAN PROPERTY INVENTORY - EVACUEE PROPERTY DIVISION - WRA **Fresno**

124A

City of Sanger

TYPE: Vacant Lot \* CODE: \_\_\_\_\_ NO: \_\_\_\_\_LEGAL OWNERS: 1. Kanagawa, Robert K. (Probably Kanagawa)

348 2. \_\_\_\_\_

7660 3. \_\_\_\_\_

Vol. 29 (LAST NAME) (MIDDLE) (FIRST)

OWNERS' ADDRESSES: 1. Route 2, Box 606, Sanger

Lts. 23-25 2. \_\_\_\_\_

Block 66 3. \_\_\_\_\_

LOCATION OF PROPERTY: (PROJECT OR P.O.) (COUNTY) (STATE)  
K St., Sanger, Fresno Co., California

(NO. AND STREET) (P.O.) (COUNTY) (STATE)

SIZE OF LOT: 3 Lots Each - 25' x 150' (800 Block)

STRUCTURES: \_\_\_\_\_

ACTUAL VALUE: \$ \_\_\_\_\_ \$ \_\_\_\_\_ \$ \_\_\_\_\_

(LAND) (STRUCTURES) (TOTAL)

ASSESSED VALUE: \$ 150- \$ - \$ 150-

(LAND) (STRUCTURES) (TOTAL)

OPERATED BY: \_\_\_\_\_

(NAME) (ADDRESS)

LEASE PERIOD: \_\_\_\_\_

(FROM: DATE) (TO: DATE)

INDEBTEDNESS: \$ \_\_\_\_\_

(AMOUNT) (DATE INCURRED) (DATE DUE)

CREDITOR: \_\_\_\_\_

(NAME) (ADDRESS)

\*  
May also be Sanger Nursery

REMARKS:

DISPOSITION:

DATE: MAY 18 1943

INVESTIGATOR:



## URBAN PROPERTY INVENTORY - EVACUEE PROPERTY DIVISION - WRA

Fresno

124 B

City of Sanger

TYPE: Maybe also (Sanger) Nursery\* CODE: \_\_\_\_\_ NO: \_\_\_\_\_LEGAL OWNERS: 1. Kamagawa, Robert K. (Kamagawa)

348 2. \_\_\_\_\_

7660 3. \_\_\_\_\_

Vol. 29 (LAST NAME) (MIDDLE) (FIRST)

OWNERS' ADDRESSES: 1. Route 2, Box 606, Sanger, California

2. \_\_\_\_\_

3. \_\_\_\_\_

Lots 23-25

Block 66 (PROJECT OR P.O.) (COUNTY) (STATE)

LOCATION OF PROPERTY: K Street Sanger, Fresno Co., California

(NO. AND STREET) (P.O.) (COUNTY) (STATE)

SIZE OF LOT: 3 Lots - Each 25' x 150' - (800 Block)

STRUCTURES: \_\_\_\_\_

ACTUAL VALUE: \$ \_\_\_\_\_ \$ \_\_\_\_\_ \$ \_\_\_\_\_

(LAND) (STRUCTURES) (TOTAL)

ASSESSED VALUE: \$ 150- \$ - \$ 150-

(LAND) (STRUCTURES) (TOTAL)

OPERATED BY: \_\_\_\_\_

(NAME) (ADDRESS)

LEASE PERIOD: \_\_\_\_\_

(FROM: DATE) (TO: DATE)

INDEBTEDNESS: \$ \_\_\_\_\_

(AMOUNT) (DATE INCURRED) (DATE DUE)

CREDITOR: \_\_\_\_\_

(NAME) (ADDRESS)

\*Vacant Lot

REMARKS:

DISPOSITION:

DATE: MAY 18 1943

INVESTIGATOR:



## URBAN PROPERTY INVENTORY - EVACUEE PROPERTY DIVISION - WRA

Fresno

125

City of Fresno

TYPE: Vacant Lot CODE: \_\_\_\_\_ NO: \_\_\_\_\_LEGAL OWNERS: 1. Kamikawa, Kaoru

3891 2. \_\_\_\_\_

5491 3. \_\_\_\_\_

Vol. 19 (LAST NAME) (MIDDLE) (FIRST)

OWNERS' ADDRESSES: 1. Box 1314, Fresno

Kearney Blvd. 2. \_\_\_\_\_

Heights - Lts. 3. \_\_\_\_\_

17,18, Blk. 35 (PROJECT OR P.O.) (COUNTY) (STATE)

LOCATION OF PROPERTY: Martin Avenue, Fresno, Fresno Co., California

(NO. AND STREET) (P.O.) (COUNTY) (STATE)

SIZE OF LOT: 2 Lots Each 25' x 150' - N. Side Martin Avenue Between Fresno & Mariposa Aves.

STRUCTURES: \_\_\_\_\_

ACTUAL VALUE: \$ \_\_\_\_\_ \$ \_\_\_\_\_ \$ \_\_\_\_\_

(LAND) (STRUCTURES) (TOTAL)

ASSESSED VALUE: \$ 175- \$ - \$ 175-

(LAND) (STRUCTURES) (TOTAL)

OPERATED BY: \_\_\_\_\_

(NAME) (ADDRESS)

LEASE PERIOD: \_\_\_\_\_

(FROM: DATE) (TO: DATE)

INDEBTEDNESS: \$ \_\_\_\_\_

(AMOUNT) (DATE INCURRED) (DATE DUE)

CREDITOR: \_\_\_\_\_

(NAME) (ADDRESS)

REMARKS:

DISPOSITION:

DATE: MAY 18 1943

INVESTIGATOR:



## URBAN PROPERTY INVENTORY - EVACUEE PROPERTY DIVISION - WRA

City of Fresno

S

127

TYPE: \_\_\_\_\_ CODE: \_\_\_\_\_ NO: \_\_\_\_\_

LEGAL OWNERS: 1. Kamikawa, Thomas T.423-424

2. \_\_\_\_\_

5140

3. \_\_\_\_\_

Vol. 18

(LAST NAME)

(MIDDLE)

(FIRST)

OWNERS' ADDRESSES: 1. \_\_\_\_\_

Lts. 5, 64,

2. \_\_\_\_\_

Block 35

3. \_\_\_\_\_

(PROJECT OR P.O.)

(COUNTY)

(STATE)

LOCATION OF PROPERTY: F Street, Fresno, Fresno Co., California

(NO. AND STREET)

(P.O.)

(COUNTY)

(STATE)

SIZE OF LOT: 3 Lts. Each 25' x 150' (600 Block)

STRUCTURES: \_\_\_\_\_

ACTUAL VALUE: \$ \_\_\_\_\_ \$ \_\_\_\_\_ \$ \_\_\_\_\_

(LAND)

(STRUCTURES)

(TOTAL)

ASSESSED VALUE: \$ 525- \$ 750- \$ 1275-

(LAND)

(STRUCTURES)

(TOTAL)

OPERATED BY: \_\_\_\_\_

(NAME)

(ADDRESS)

LEASE PERIOD: \_\_\_\_\_

(FROM: DATE)

(TO: DATE)

INDEBTEDNESS: \$ \_\_\_\_\_

(AMOUNT)

(DATE INCURRED)

(DATE DUE)

CREDITOR: \_\_\_\_\_

(NAME)

(ADDRESS)

REMARKS: Transferred from Kamikawa, Thomas T. and Meyeko to Sample, S. C. and  
Louise M. 5/19/42  
975 Yale Avenue, Fresno, California

DISPOSITION:

DATE:

INVESTIGATOR:



## URBAN PROPERTY INVENTORY - EVACUEE PROPERTY DIVISION - WRA

Fresno

132

City of Fresno

TYPE: Residence CODE: \_\_\_\_\_ NO: \_\_\_\_\_LEGAL OWNERS: 1. Kanase, Shunichi

4279 2. \_\_\_\_\_

5528 3. \_\_\_\_\_

Vol. 19 (LAST NAME) (MIDDLE) (FIRST)

OWNERS' ADDRESSES: 1. Route 9, Box 655, Fresno

Paige Tract 2. \_\_\_\_\_

Lts. 11,12,Blk. 3. \_\_\_\_\_

11 (PROJECT OR P.O.) (COUNTY) (STATE)

LOCATION OF PROPERTY: A Street Fresno, Fresno Co., California

(NO. AND STREET) (P.O.) (COUNTY) (STATE)

SIZE OF LOT: 2 Lts. Each 25' x 150' on W Side A St. Between Kern and Inyo Sts.

STRUCTURES: \_\_\_\_\_

ACTUAL VALUE: \$ \_\_\_\_\_ \$ \_\_\_\_\_ \$ \_\_\_\_\_

(LAND) (STRUCTURES) (TOTAL)

ASSESSED VALUE: \$ 250- \$ 600- \$ 850-

(LAND) (STRUCTURES) (TOTAL)

OPERATED BY: \_\_\_\_\_

(NAME) (ADDRESS)

LEASE PERIOD: \_\_\_\_\_

(FROM: DATE) (TO: DATE)

INDEBTEDNESS: \$ \_\_\_\_\_

(AMOUNT) (DATE INCURRED) (DATE DUE)

CREDITOR: \_\_\_\_\_

(NAME) (ADDRESS)

REMARKS:

DISPOSITION:

DATE: MAY 18 1943

INVESTIGATOR:



URBAN PROPERTY INVENTORY - EVACUEE PROPERTY DIVISION - WRA **Fresno**

135

City of Fowler

TYPE: Vacant Lot CODE: \_\_\_\_\_ NO: \_\_\_\_\_LEGAL OWNERS: 1. Kanenaga, Hatsuyo

393 2. \_\_\_\_\_

7367 3. \_\_\_\_\_

Vol. 27 (LAST NAME) (MIDDLE) (FIRST)

OWNERS' ADDRESSES: 1. P.O. Box 524, Fowler

Lts. 25,26 2. \_\_\_\_\_

Blk. 70 3. \_\_\_\_\_

LOCATION OF PROPERTY: (PROJECT OR P.O.) (COUNTY) (STATE)  
10th Street Fowler, Fresno Co., California

(NO. AND STREET) (P.O.) (COUNTY) (STATE)

SIZE OF LOT: 2 Lots Each - 25' x 150' One Side 10th Between Main and Fresno

STRUCTURES: \_\_\_\_\_

ACTUAL VALUE: \$ \_\_\_\_\_ \$ \_\_\_\_\_ \$ \_\_\_\_\_

(LAND) (STRUCTURES) (TOTAL)

ASSESSED VALUE: \$ 60- \$ - \$ 60-

(LAND) (STRUCTURES) (TOTAL)

OPERATED BY: \_\_\_\_\_

(NAME) (ADDRESS)

LEASE PERIOD: \_\_\_\_\_

(FROM: DATE) (TO: DATE)

INDEBTEDNESS: \$ \_\_\_\_\_

(AMOUNT) (DATE INCURRED) (DATE DUE)

CREDITOR: \_\_\_\_\_

(NAME) (ADDRESS)

REMARKS:

DISPOSITION:

DATE: MAY 18 1943

INVESTIGATOR:



URBAN PROPERTY INVENTORY - EVACUEE PROPERTY DIVISION - WRA  
City of Fresno

S

TYPE: \_\_\_\_\_ CODE: \_\_\_\_\_ NO: \_\_\_\_\_

LEGAL OWNERS: 1. Kataoka, Masaichi  
378 2. " ; Asano  
5136 3. \_\_\_\_\_

Vol. 18 (LAST NAME) (MIDDLE) (FIRST)

OWNERS' ADDRESSES: 1. \_\_\_\_\_  
Lts. 7, 8 2. \_\_\_\_\_  
Block 32 3. \_\_\_\_\_

(PROJECT OR P.O.) (COUNTY) (STATE)  
LOCATION OF PROPERTY: E Street Fresno, Fresno County, California

(NO. AND STREET) (P.O.) (COUNTY) (STATE)  
SIZE OF LOT: 2 Lts. Each 25' x 150' (600 Block) (637 E. St.)

STRUCTURES: \_\_\_\_\_

ACTUAL VALUE: \$ \_\_\_\_\_ \$ \_\_\_\_\_ \$ \_\_\_\_\_  
(LAND) (STRUCTURES) (TOTAL)

ASSESSED VALUE: \$ 350- \$ 880- \$ 1230-  
(LAND) (STRUCTURES) (TOTAL)

OPERATED BY: \_\_\_\_\_  
(NAME) (ADDRESS)

LEASE PERIOD: \_\_\_\_\_  
(FROM: DATE) (TO: DATE)

INDEBTEDNESS: \$ \_\_\_\_\_  
(AMOUNT) (DATE INCURRED) (DATE DUE)

CREDITOR: \_\_\_\_\_  
(NAME) (ADDRESS)

REMARKS:

Transferred from Kataoka, Masaichi and Asano to Wong, Georgia 5/13/42  
1021 G St., Fresno, Calif.

DISPOSITION:

DATE:

INVESTIGATOR:



URBAN PROPERTY INVENTORY - EVACUEE PROPERTY DIVISION - WRA Fresno

138

City of Fresno

TYPE: \_\_\_\_\_ CODE: \_\_\_\_\_ NO: \_\_\_\_\_

LEGAL OWNERS: 1. Kataoka, Masaichi  
648 2. " , Asano  
5162 3. \_\_\_\_\_

Vol. 18 (LAST NAME) (MIDDLE) Co. (FIRST)

OWNERS' ADDRESSES: 1. 1411 Tulare St., Fresno, Fresno, CaliforniaN.W.  $\frac{1}{4}$  of Lt. 3 2. \_\_\_\_\_

Bl. 51 3. \_\_\_\_\_

(PROJECT OR P.O.) (COUNTY) (STATE)

LOCATION OF PROPERTY: G St., Fresno, Fresno Co., California

(NO. AND STREET) (P.O.) (COUNTY) (STATE)

SIZE OF LOT: 12 $\frac{1}{2}$ ' x 150' (900 Block)

STRUCTURES: \_\_\_\_\_

ACTUAL VALUE: \$ \_\_\_\_\_ \$ \_\_\_\_\_ \$ \_\_\_\_\_

(LAND) (STRUCTURES) (TOTAL)

ASSESSED VALUE: \$ 750- \$ 750- \$ 1500-

(LAND) (STRUCTURES) (TOTAL)

OPERATED BY: \_\_\_\_\_

(NAME) (ADDRESS)

LEASE PERIOD: \_\_\_\_\_

(FROM: DATE) (TO: DATE)

INDEBTEDNESS: \$ \_\_\_\_\_

(AMOUNT) (DATE INCURRED) (DATE DUE)

CREDITOR: \_\_\_\_\_

(NAME) (ADDRESS)

REMARKS:

DISPOSITION:

DATE: MAY 18 1943

INVESTIGATOR:



URBAN PROPERTY INVENTORY - EVACUEE PROPERTY DIVISION - WRA Fresno

140

City of Fresno

TYPE: Vacant Lot CODE: \_\_\_\_\_ NO: \_\_\_\_\_LEGAL OWNERS: 1. Kato, Kazuo

15440 2. \_\_\_\_\_

6741 3. \_\_\_\_\_

Vol. 25 (LAST NAME) (MIDDLE) (FIRST)

OWNERS' ADDRESSES: 1. 1333 Kern Street, Fresno

Florence, Lt. 9 2. \_\_\_\_\_

Block 3 3. \_\_\_\_\_

(PROJECT OR P.O.) (COUNTY) (STATE)

LOCATION OF PROPERTY: Eunice Fresno, Fresno Co., California

(NO. AND STREET) (P.O.) (COUNTY) (STATE)

SIZE OF LOT: 60' x 150' on E Side Eunice Between California & Lorena Avenues

STRUCTURES: \_\_\_\_\_

ACTUAL VALUE: \$ \_\_\_\_\_ \$ \_\_\_\_\_ \$ \_\_\_\_\_

(LAND) (STRUCTURES) (TOTAL)

ASSESSED VALUE: \$ 150- \$ - \$ 150-

(LAND) (STRUCTURES) (TOTAL)

OPERATED BY: \_\_\_\_\_

(NAME) (ADDRESS)

LEASE PERIOD: \_\_\_\_\_

(FROM: DATE) (TO: DATE)

INDEBTEDNESS: \$ \_\_\_\_\_

(AMOUNT) (DATE INCURRED) (DATE DUE)

CREDITOR: \_\_\_\_\_

(NAME) (ADDRESS)

REMARKS:

DISPOSITION:

DATE: MAY 18 1943

INVESTIGATOR:



## URBAN PROPERTY INVENTORY - EVACUEE PROPERTY DIVISION - WRA

S

141

City of Fowler

TYPE: \_\_\_\_\_ CODE: \_\_\_\_\_ NO: \_\_\_\_\_

LEGAL OWNERS: 1. Kato, Shinae (Shinaye)

81 2. \_\_\_\_\_

7334 3. \_\_\_\_\_

Vol. 27 (LAST NAME) (MIDDLE) (FIRST)

OWNERS' ADDRESSES: 1. \_\_\_\_\_

Blk. 46, 2. \_\_\_\_\_

Lts. 7,8 3. \_\_\_\_\_

Blk. 45, Lts. (PROJECT OR P.O.) (COUNTY) (STATE)

LOCATION OF PROPERTY: Fowler, Fresno County, California

22,23 (NO. AND STREET) (P.O.) (COUNTY) (STATE)

SIZE OF LOT: (Over)

STRUCTURES: \_\_\_\_\_

ACTUAL VALUE: \$ \_\_\_\_\_ \$ \_\_\_\_\_ \$ \_\_\_\_\_

(LAND) (STRUCTURES) (TOTAL)

ASSESSED VALUE: \$ 180- \$ 600- \$ 780-

(LAND) (STRUCTURES) (TOTAL)

OPERATED BY: \_\_\_\_\_

(NAME) (ADDRESS)

LEASE PERIOD: \_\_\_\_\_

(FROM: DATE) (TO: DATE)

INDEBTEDNESS: \$ \_\_\_\_\_

(AMOUNT) (DATE INCURRED) (DATE DUE)

CREDITOR: \_\_\_\_\_

(NAME) (ADDRESS)

REMARKS: Block 45, Lts. 22,23 transferred to Gonzales, Martin and Benito 7/30/42  
Block 46, Lots 7,8 transferred to Rodriguez, Florentino L. 7/30/42  
P. O. Box 181, Gilroy

4 Lts. Each 25' x 150' - Lts. in Blk. 45-East Side 7th Street Between  
Fresno and Main Streets  
Lots in Bk. 46 - W. Side 6th Street Between Fresno and Vine Streets

DISPOSITION:

DATE:

INVESTIGATOR:



URBAN PROPERTY INVENTORY - EVACUEE PROPERTY DIVISION - WRA Fresno

142

City of Fowler

TYPE: \_\_\_\_\_ CODE: \_\_\_\_\_ NO: \_\_\_\_\_

LEGAL OWNERS: 1. Kato, Shinae (Shinaye)

141 2. \_\_\_\_\_

7339 3. \_\_\_\_\_

Vol. 27 (LAST NAME) (MIDDLE) (FIRST)

OWNERS' ADDRESSES: 1. Fowler, Fresno Co., California

Lts. 1,2 - Blk. 70 2. \_\_\_\_\_

3. \_\_\_\_\_

(PROJECT OR P.O.) (COUNTY) (STATE)

LOCATION OF PROPERTY: 9th St. Fowler Fresno Co., California

(NO. AND STREET) (P.O.) (COUNTY) (STATE)

SIZE OF LOT: 2 Lts. Each - 25' x 150' on W. Side 9th Between Main and Fresno Sts.

STRUCTURES: \_\_\_\_\_

ACTUAL VALUE: \$ \_\_\_\_\_ \$ \_\_\_\_\_ \$ \_\_\_\_\_

(LAND) (STRUCTURES) (TOTAL)

ASSESSED VALUE: \$ 80- \$ 400- \$ 480-

(LAND) (STRUCTURES) (TOTAL)

OPERATED BY: \_\_\_\_\_

(NAME) (ADDRESS)

LEASE PERIOD: \_\_\_\_\_

(FROM: DATE) (TO: DATE)

INDEBTEDNESS: \$ \_\_\_\_\_

(AMOUNT) (DATE INCURRED) (DATE DUE)

CREDITOR: \_\_\_\_\_

(NAME) (ADDRESS)

REMARKS:

DISPOSITION:

DATE: MAY 18 1943

INVESTIGATOR:



URBAN PROPERTY INVENTORY - EVACUEE PROPERTY DIVISION - WRA **Fresno**

145

City of Fresno

TYPE: Residence CODE: \_\_\_\_\_ NO: \_\_\_\_\_LEGAL OWNERS: 1. Kawai, Isel (Probably Ise L.)

376 2. \_\_\_\_\_

5136 3. \_\_\_\_\_

Vol. 18 (LAST NAME) (MIDDLE) (FIRST)

OWNERS' ADDRESSES: 1. 651 E. Street, Fresno, California

Lts. 3,4 2. \_\_\_\_\_

Block 32 3. \_\_\_\_\_

(PROJECT OR P.O.) (COUNTY) (STATE)

LOCATION OF PROPERTY: E Street Fresno, Fresno Co., California

(NO. AND STREET) (P.O.) (COUNTY) (STATE)

SIZE OF LOT: 2 Lts. Each 25' x 150' (600 Block)

STRUCTURES: \_\_\_\_\_

ACTUAL VALUE: \$ \_\_\_\_\_ \$ \_\_\_\_\_ \$ \_\_\_\_\_

(LAND) (STRUCTURES) (TOTAL)

ASSESSED VALUE: \$ 350- \$ 200- \$ 550-

(LAND) (STRUCTURES) (TOTAL)

OPERATED BY: \_\_\_\_\_

(NAME) (ADDRESS)

LEASE PERIOD: \_\_\_\_\_

(FROM: DATE) (TO: DATE)

INDEBTEDNESS: \$ \_\_\_\_\_

(AMOUNT) (DATE INCURRED) (DATE DUE)

CREDITOR: \_\_\_\_\_

(NAME) (ADDRESS)

REMARKS:

DISPOSITION:

DATE: MAY 18 1943

INVESTIGATOR:



FARM PROPERTY INVENTORY - EVACUEE PROPERTY DIVISION - WRA

498

TYPE: \_\_\_\_\_ CODE: \_\_\_\_\_ NO: \_\_\_\_\_

LEGAL OWNERS: 1. Kawakami, Yukio  
 5688 2. ", Temaye  
 590-1 3. \_\_\_\_\_  
Fresno City (LAST NAME) (MIDDLE) (FIRST)

OWNERS' ADDRESSES: 1. \_\_\_\_\_  
 2. \_\_\_\_\_  
 3. \_\_\_\_\_  
 (PROJECT OR P.O.) (COUNTY) (STATE)

LOCATION OF PROPERTY: Fresno, Fresno Co., California  
 (RFD, ETC.) (P.O.) (COUNTY) (STATE)

GROSS ACREAGE: \_\_\_\_\_ CULTIVATED ACREAGE: \_\_\_\_\_

CROPS GROWN: \_\_\_\_\_  
 :  
 :  
 (CROP) (ACREAGE) (CROP) (ACREAGE)

SOIL: \_\_\_\_\_  
 (TYPE) (PRODUCTIVITY INDEX)

STRUCTURES: House ? (Personal Property - \$190)

ACTUAL VALUE: \$ \_\_\_\_\_ \$ \_\_\_\_\_ \$ \_\_\_\_\_  
 (LAND) (STRUCTURES) (TOTAL)

ASSESSED VALUE: \$ 125- \$ 520- \$ 645-  
 (LAND) (STRUCTURES) (TOTAL)

OPERATED BY: \_\_\_\_\_  
 (NAME) (ADDRESS)

LEASE PERIOD: \_\_\_\_\_  
 (FROM: DATE) (TO: DATE)

INDEBTEDNESS: \$

(AMOUNT)

(DATED INCURRED)

(DATE DUE)

CREDITOR:

(NAME)

(ADDRESS)

LEGAL DESCRIPTION:

Park View Tract: E. 50' of Lt. 9: S-5: T-14:S.: R-20E.

(Block # None) 50' x 100' N. Side Mildred Ave., E. of Humboldt  
Avenue

REMARKS:

DISPOSITION:

DATE:

INVESTIGATOR:



URBAN PROPERTY INVENTORY - EVACUEE PROPERTY DIVISION - WRA **Fresno**

146

Town of Del Rey

TYPE: T.E. Company CODE: \_\_\_\_\_ NO: \_\_\_\_\_LEGAL OWNERS: 1. Kawasaki, George

31933 2. \_\_\_\_\_

4171 3. \_\_\_\_\_

(LAST NAME) (MIDDLE) (FIRST)

OWNERS' ADDRESSES: 1. P.O. Box 43, Del Rey, California

5 Prairie 2. \_\_\_\_\_

Lt. 6, Blk. 4 3. \_\_\_\_\_

(PROJECT OR P.O.) (COUNTY) (STATE)

LOCATION OF PROPERTY: R. R. Avenue \* Fresno Co., California

(NO. AND STREET) (P.O.) (COUNTY) (STATE)

SIZE OF LOT: 50' x 150'

STRUCTURES: \_\_\_\_\_

ACTUAL VALUE: \$ \_\_\_\_\_ \$ \_\_\_\_\_ \$ \_\_\_\_\_

(LAND) (STRUCTURES) (TOTAL)

ASSESSED VALUE: \$ 300- \$ 300- \$ 600-

(LAND) (STRUCTURES) (TOTAL)

OPERATED BY: \_\_\_\_\_

(NAME) (ADDRESS)

LEASE PERIOD: \_\_\_\_\_

(FROM: DATE) (TO: DATE)

INDEBTEDNESS: \$ \_\_\_\_\_

(AMOUNT) (DATE INCURRED) (DATE DUE)

CREDITOR: \_\_\_\_\_

(NAME) (ADDRESS)

\*South Side Between 3rd and 4th Sts.

REMARKS:

DISPOSITION:

DATE: MAY 18 1943

INVESTIGATOR:



City of Fowler

TYPE: Vacant Lot CODE: \_\_\_\_\_ NO: \_\_\_\_\_LEGAL OWNERS: 1. Kawasaki, George

391 2. \_\_\_\_\_

7367 3. \_\_\_\_\_

Vol. 27 (LAST NAME) (MIDDLE) (FIRST)

OWNERS' ADDRESSES: 1. 4 Yukiko Harada, P.O. Box 270, Fowler

Lt. 5 2. \_\_\_\_\_

Block 70 3. \_\_\_\_\_

(PROJECT OR P.O.) (COUNTY) (STATE)

LOCATION OF PROPERTY: 9th Street Fowler, Fresno Co., California

(NO. AND STREET) (P.O.) (COUNTY) (STATE)

SIZE OF LOT: 25' x 150' on W. Side 9th Between Main and Fresno Sts.

STRUCTURES: \_\_\_\_\_

ACTUAL VALUE: \$ \_\_\_\_\_ \$ \_\_\_\_\_ \$ \_\_\_\_\_

(LAND) (STRUCTURES) (TOTAL)

ASSESSED VALUE: \$ 30- \$ - \$ 30-

(LAND) (STRUCTURES) (TOTAL)

OPERATED BY: \_\_\_\_\_

(NAME) (ADDRESS)

LEASE PERIOD: \_\_\_\_\_

(FROM: DATE) (TO: DATE)

INDEBTEDNESS: \$ \_\_\_\_\_

(AMOUNT) (DATE INCURRED) (DATE DUE)

CREDITOR: \_\_\_\_\_

(NAME) (ADDRESS)

REMARKS:

DISPOSITION:

DATE: MAY 18 1943

INVESTIGATOR:



## URBAN PROPERTY INVENTORY - EVACUEE PROPERTY DIVISION - WRA

151

City of Fresno

TYPE: \_\_\_\_\_ CODE: \_\_\_\_\_ NO: \_\_\_\_\_

LEGAL OWNERS: 1. Kebo, George4273 2. Kebo, Evelyn

5527 3. \_\_\_\_\_

Vol. 19 (LAST NAME) (MIDDLE) (FIRST)

OWNERS' ADDRESSES: 1. \_\_\_\_\_

Paige Tract 2. \_\_\_\_\_

Lts. 15,16 3. \_\_\_\_\_

Block 10 (PROJECT OR P.O.) (COUNTY) (STATE)

LOCATION OF PROPERTY: Fresno, Fresno County, California

(NO. AND STREET) (P.O.) (COUNTY) (STATE)

SIZE OF LOT: 2 Lts. Each 25' x 150' NE Corner Mayor and Inyo Streets

STRUCTURES: \_\_\_\_\_

ACTUAL VALUE: \$ \_\_\_\_\_ \$ \_\_\_\_\_ \$ \_\_\_\_\_

(LAND) (STRUCTURES) (TOTAL)

ASSESSED VALUE: \$ 225- \$ - \$ 225-

(LAND) (STRUCTURES) (TOTAL)

OPERATED BY: \_\_\_\_\_

(NAME) (ADDRESS)

LEASE PERIOD: \_\_\_\_\_

(FROM: DATE) (TO: DATE)

INDEBTEDNESS: \$ \_\_\_\_\_

(AMOUNT) (DATE INCURRED) (DATE DUE)

CREDITOR: \_\_\_\_\_

(NAME) (ADDRESS)

REMARKS:

Transferred To: Kebo, Frank 5/18/42

c/o Fresno County, Fair Grounds, Fresno, California

DISPOSITION:

DATE:

INVESTIGATOR: